

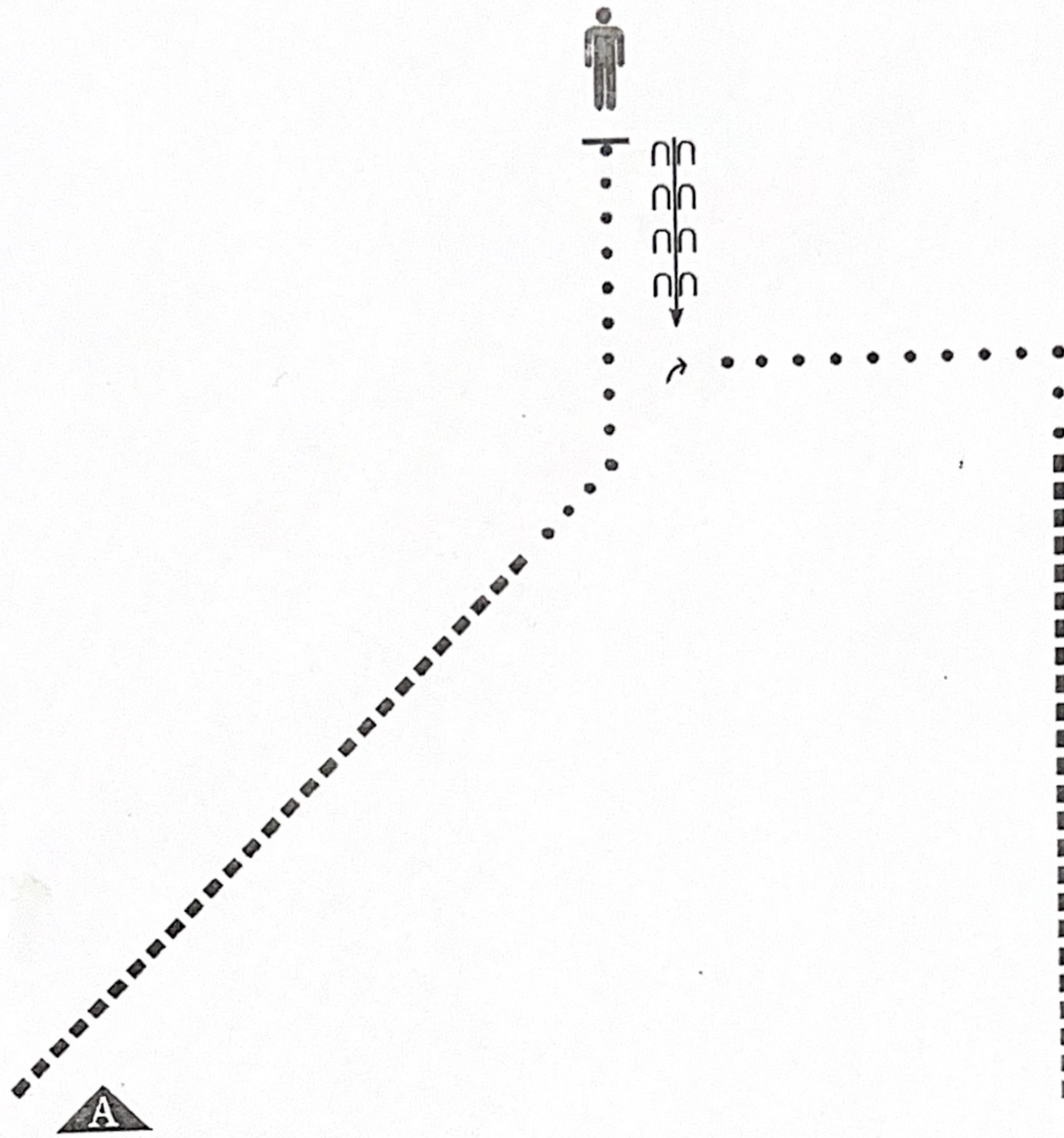



# Showmanship (ALL WALK/ TROT | MINIATURE)

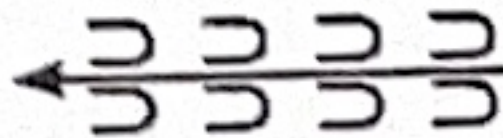

1. Trot.
2. Walk to judge.
3. Stop. Setup.
4. Inspection.
5. Back 4-5 steps.
6. Perform a 90° turn.
7. Walk square corner.
8. Trot to exit.

.....	Walk
.....	Extended Walk
-----	Trot
-----	Extended Trot
	Judge
	Back
	Cone



# Mini/Pony In Hand Trail

## Mother's Day Show

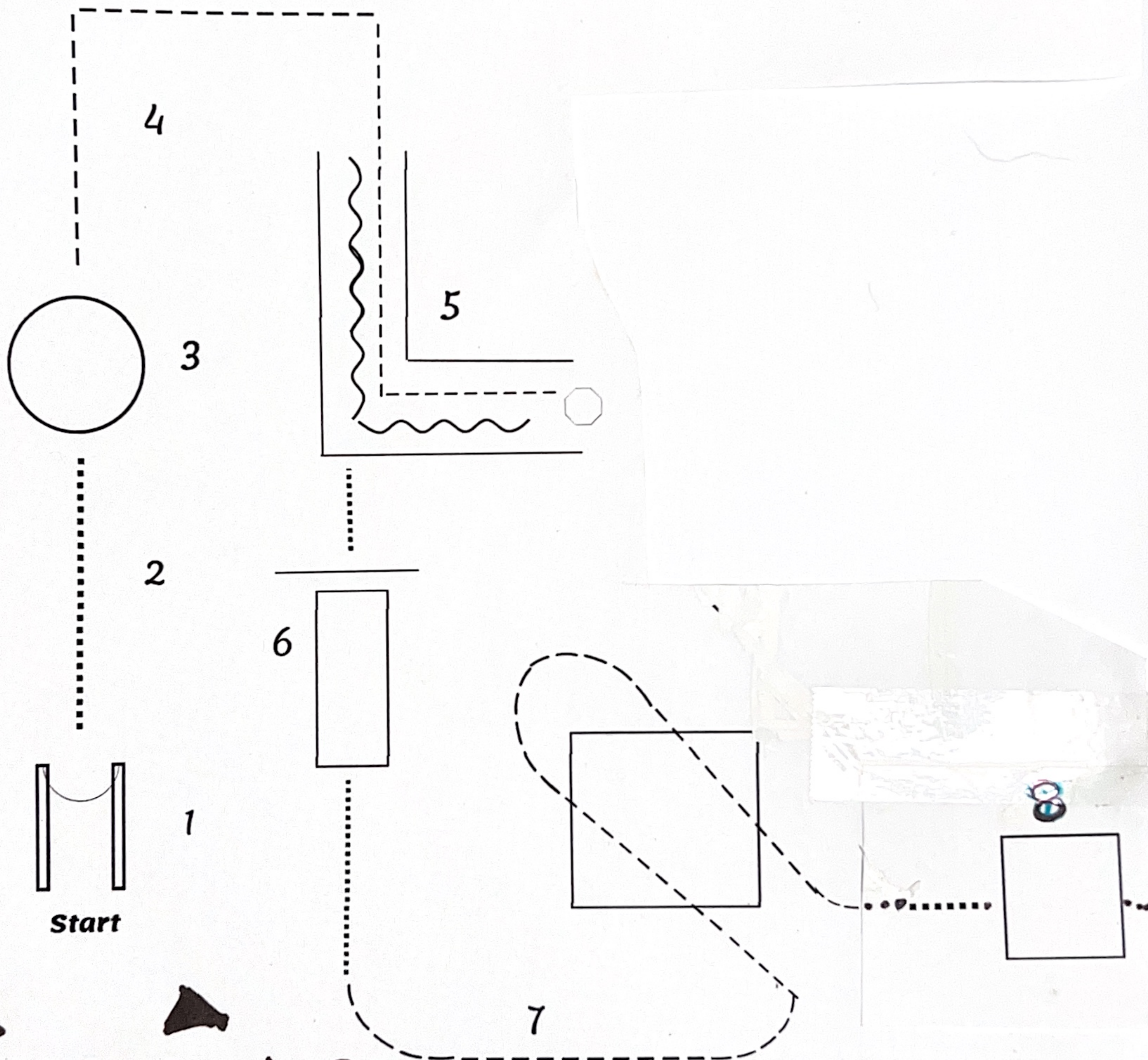

**Be Ready @ gate**

1. Left hand gate
2. walk to and into hoop with front feet
3. 360° turn in either direction on the forehand, walk out
4. Jog square corner, into L, stop
5. Back L, walk out
6. Walk over pole and bridge
7. Jog boxes as drawn
8. Walk through water box



# HUNTER

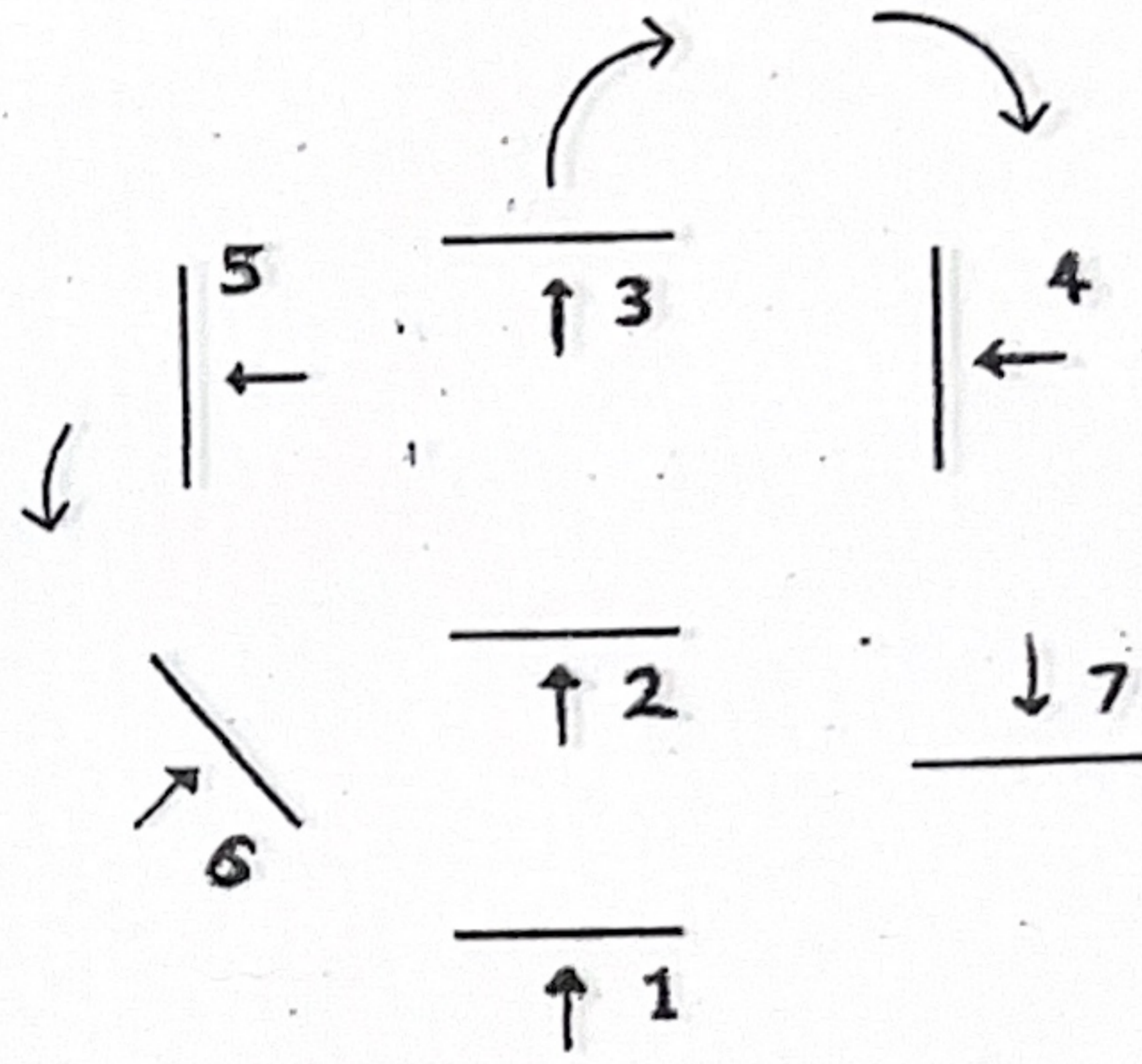

# JUMPING

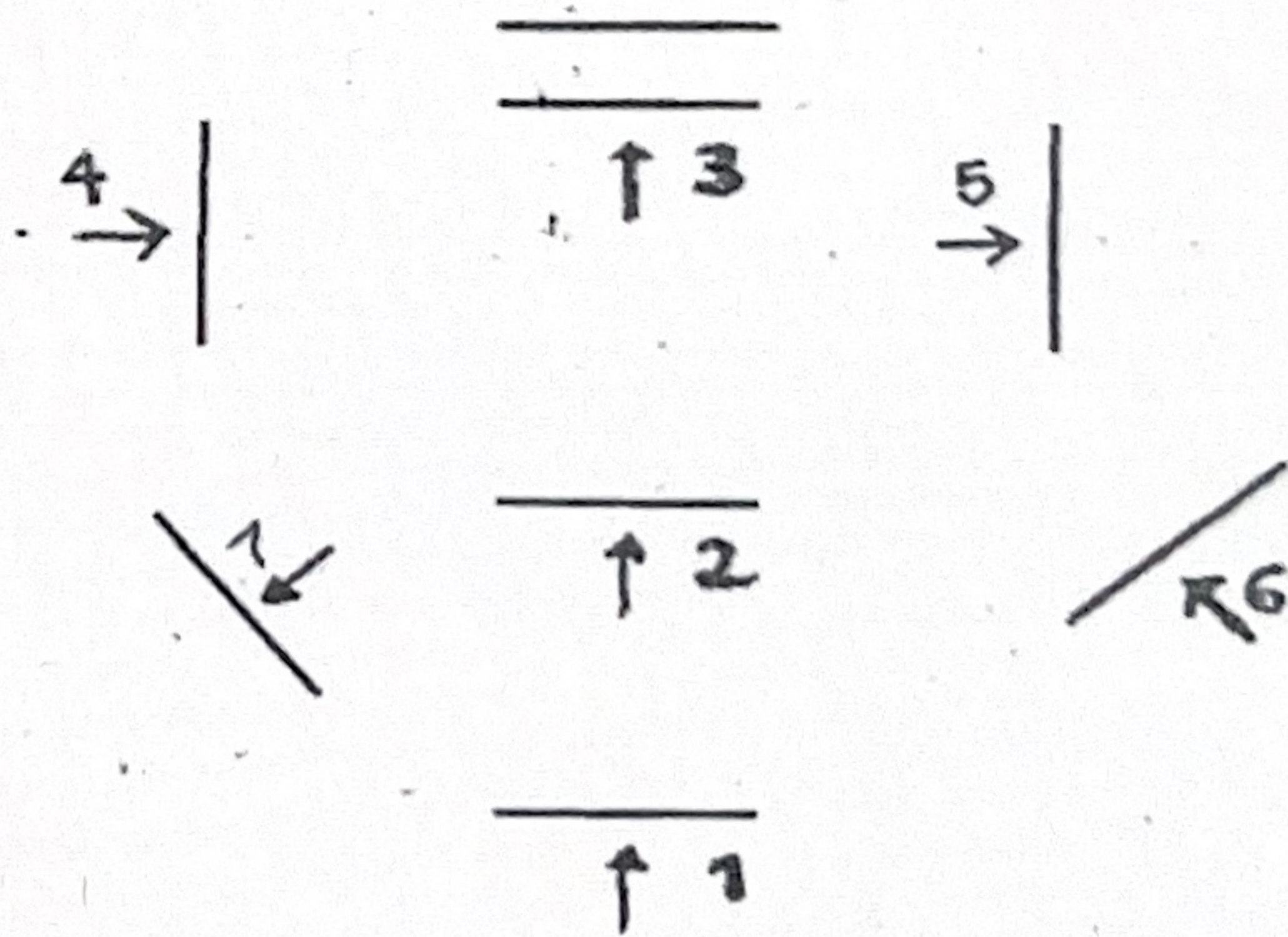



# Mini/Pony Reinsmanship

## Mother's Day Show

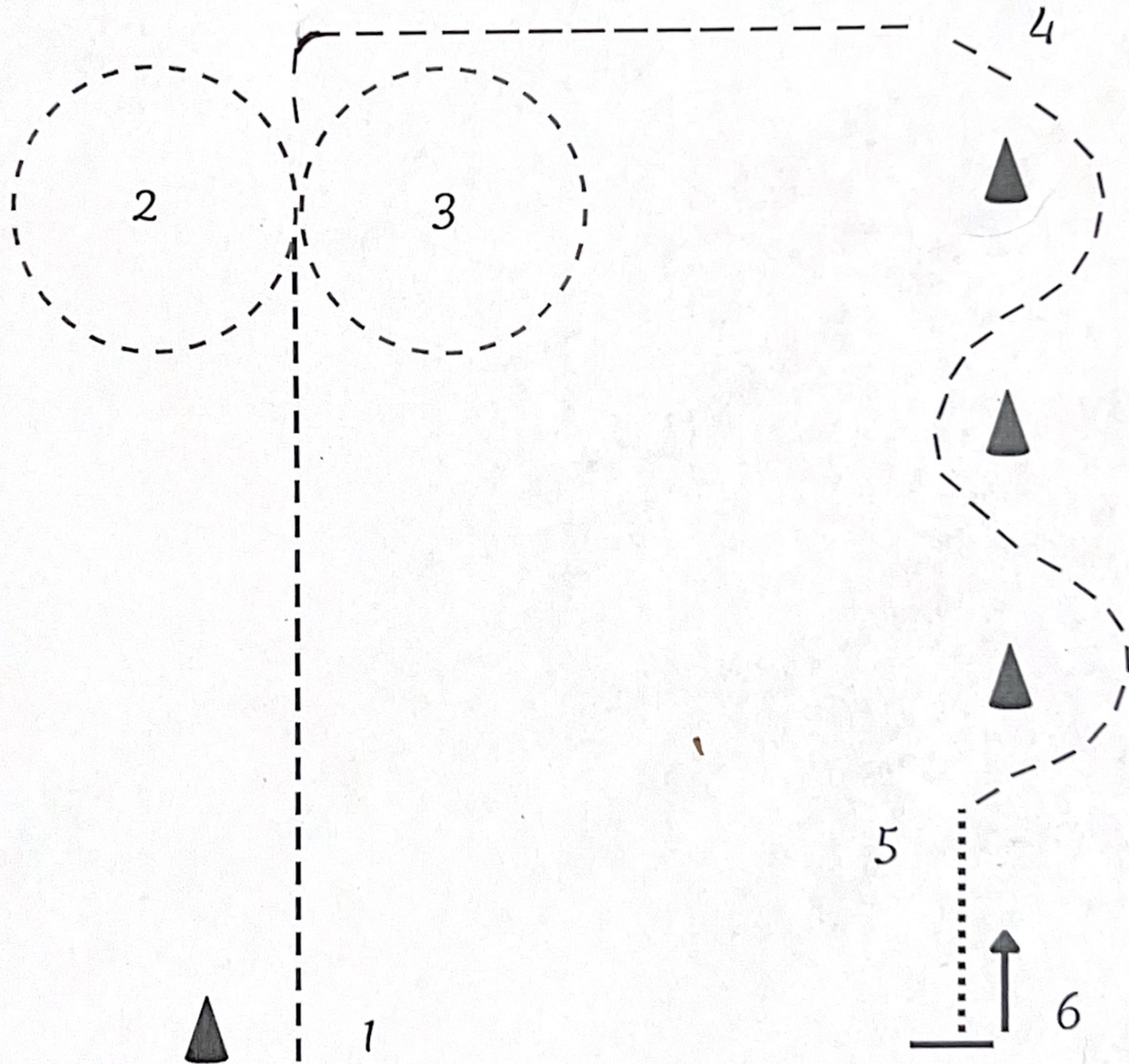

1. Enter at working trot
2. Circle left at working trot
3. Circle right at working trot
4. Slow trot serpentine
5. Break to walk at cone
6. Stop. Rein back 6 steps. Exit at walk



# OBSTACLE DRIVING

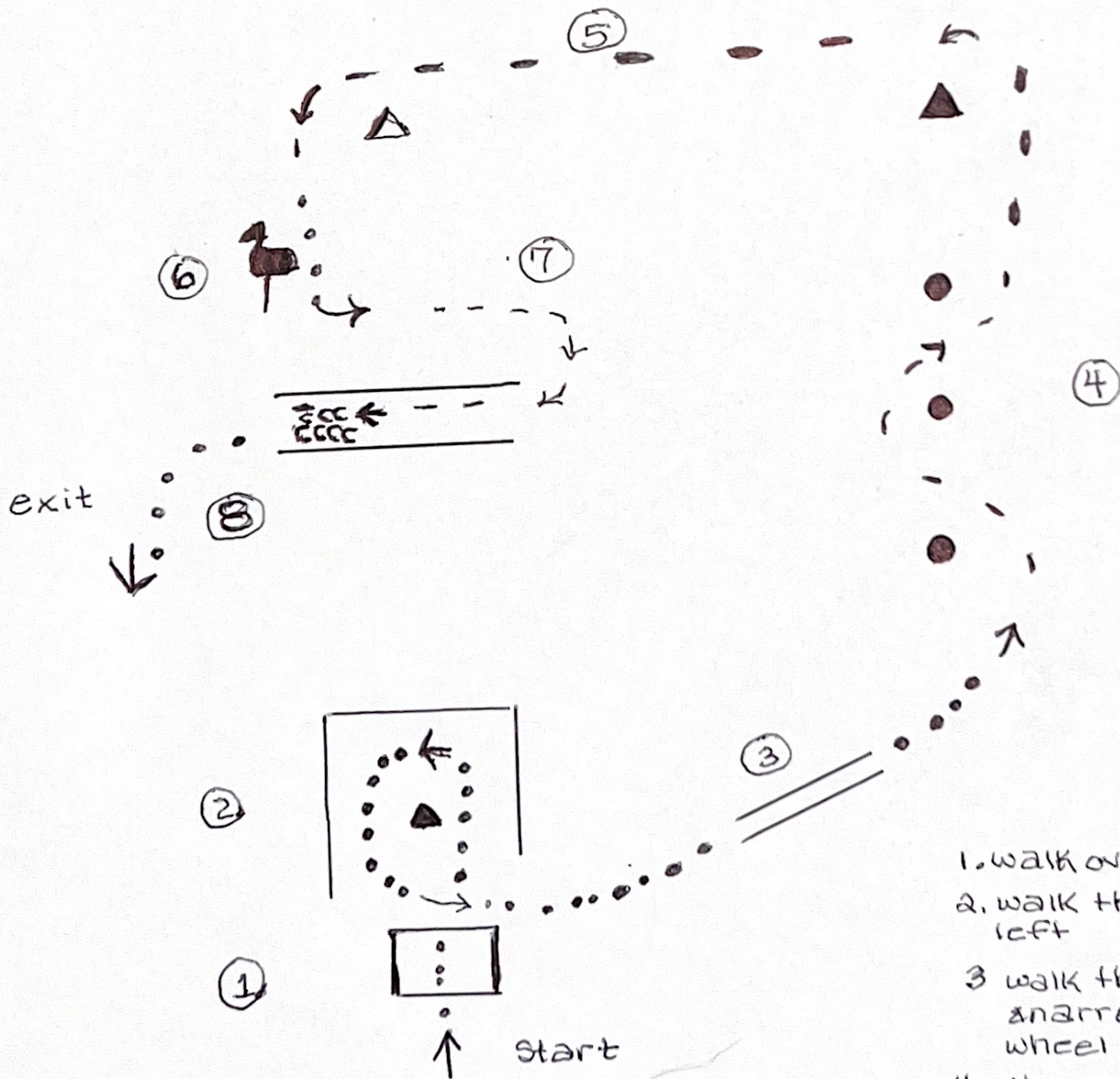

1. walk over
2. walk thru to the left
3. walk thru straight narrow, either wheel
4. Normal trot serpentine
5. Strong trot
6. walk to mail box, check mail
7. 90° pivot to left, trot into chute, stop.
8. Back one horse length.

Walk ...  
 Trot ---  
 Strong Trot - . - .  
 Back      wavy lines